

PARTS CATALOGUE/TECHNICAL GUIDE

Cal. Y621A

[SPECIFICATIONS]

Item	Cal. No.	Y621A
Movement		 <p>(x 1.0)</p>
Movement size	Outside diameter	ø27.4 mm
	Casing diameter	ø27.0 mm
	Height	4.95 mm
Time indication		Three hands (Hour, minute and second hands)
Vibrations per hour		21,600 (6 beats per second)
Additional mechanism		<ul style="list-style-type: none"> • Automatic winding • Date calendar • Instant calendar setting device
Jewels		17 jewels

SEIKO CORPORATION

PARTS CATALOGUE

Cal. Y621A

Disassembling procedures Figs. : ① ~ ④⑧

Reassembling procedures Figs. : ④⑧ ~ ①

Lubricating: Types of oil

● Moebius A

◊ SEIKO Watch Oil S-4

○ SEIKO Watch Oil S-6

Oil quantity

∞ Liberal quantity

○ Normal quantity

◊ Extremely small

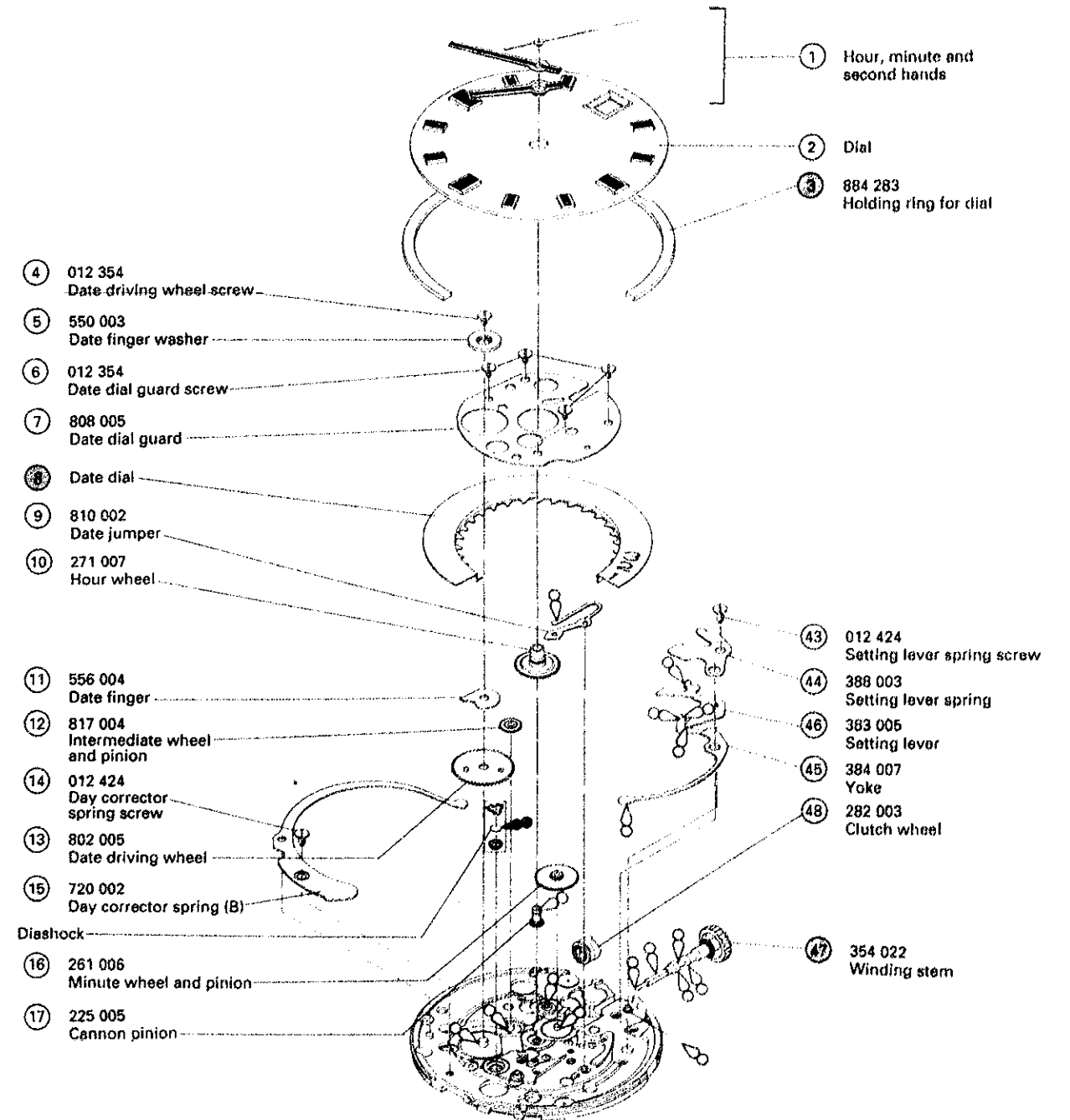

⊙ → Please see the remarks on the following pages.

PARTS CATALOGUE

Cal. Y621A

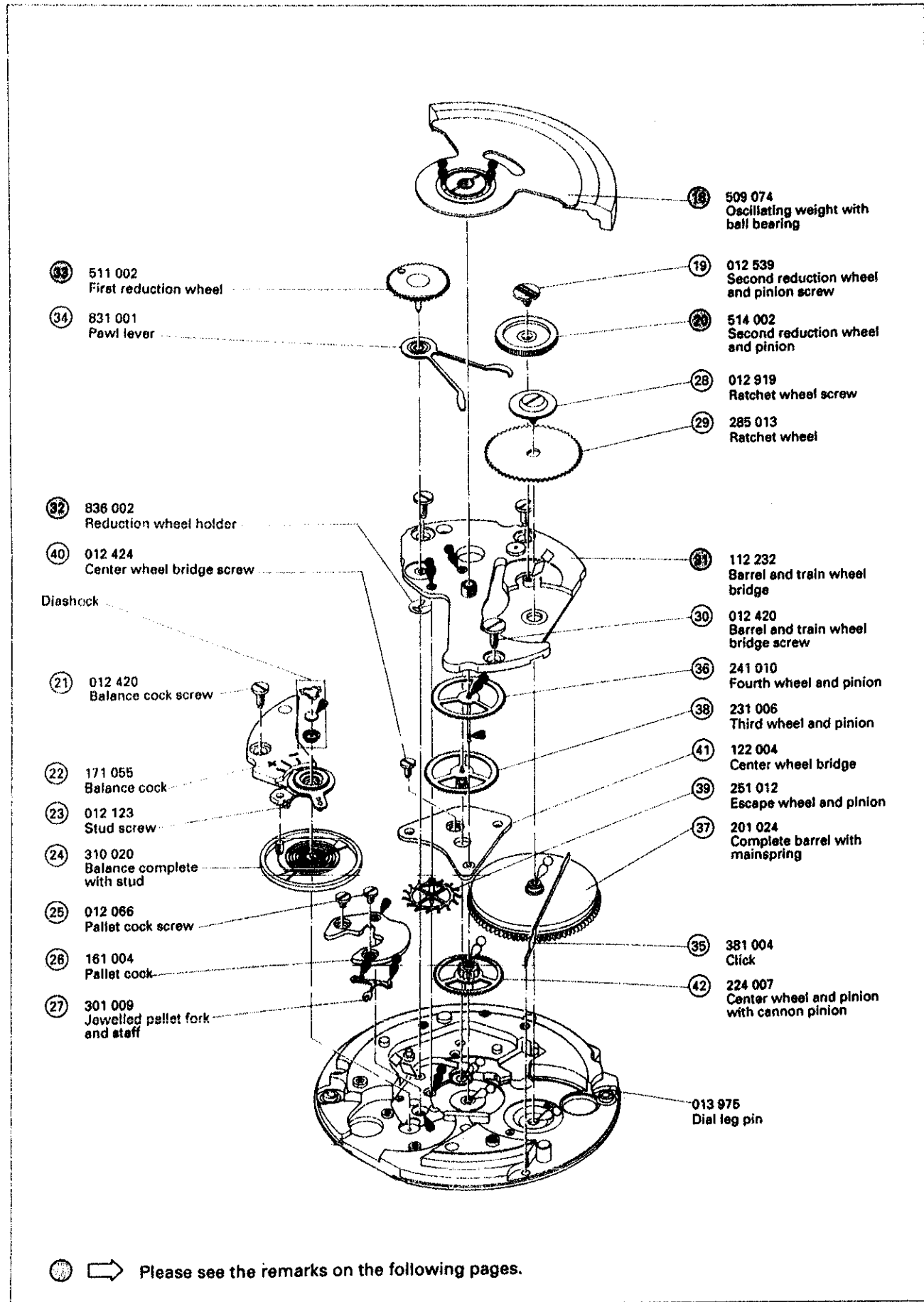

PARTS CATALOGUE

Cal. Y621A

• List of screws

Part No.	Name	Part No.	Name
012 123	Stud screw	012 424	<ul style="list-style-type: none"> Center wheel bridge screw Setting lever spring screw Day corrector spring screw
012 354	<ul style="list-style-type: none"> Date driving wheel screw Date dial guard screw 	012 539	Second reduction wheel and pinion screw
012 066	Pallet cock screw	012 919	Ratchet wheel screw
012 420	<ul style="list-style-type: none"> Barrel and train wheel bridge screw Balance cock screw 		

• List of jewels

Part No.	Name	Part No.	Name
011 146	Lower hole jewel for center wheel and pinion	011 528	Upper hole jewel for escape wheel Lower hole jewel for escape wheel
011 151	Lower hole jewel for first reduction wheel	011 532	Upper hole jewel for third wheel and pinion
011 162	Upper hole jewel for first reduction wheel	011 540	Lower hole jewel for third wheel and pinion
011 220	Diashock upper cap jewel Diashock lower cap jewel	011 715	Upper hole jewel for center wheel and pinion
011 505	Upper hole jewel for jewelled pallet fork and staff Lower hole jewel for jewelled pallet fork and staff	014 295	Diashock upper hole jewel with frame Diashock lower hole jewel with frame

PARTS CATALOGUE

Cal. Y621A

• List of tubes

Part No.	Name	Part No.	Name
013 009	Tube for barrel and train wheel bridge	013 198	Tube for pallet cock (A)
013 186	Tube for pallet cock (B)	013 199	Tube for date driving wheel
013 197	Tube for second reduction wheel and pinion	013 975	Dial leg pin

• Other parts

Part No.	Name	Part No.	Name
341 007	Regulator	014 217	Diashock upper spring Diashock lower spring
345 007	Stud holder	014 293	Diashock upper frame
		014 294	Diashock lower frame

Remarks:

③ Holding ring for dial 884 283

④7 Winding stem 354 022

The types of holding ring for dial and winding stem are determined based on the design of cases. Check the case number and refer to "PULSAR Casing Parts Catalogue" to choose their corresponding types.

⑧ Date dial

The type of date dial is determined based on the design of cases. Refer to the table below, or check the case number and refer to the "PULSAR Casing Parts Catalogue" to choose a corresponding date dial.

Part No.	Crown position	Calendar frame position	Ground color	Figure color
801 399	4 o'clock	3 o'clock	White	Black
801 464	4 o'clock	3 o'clock	Black	White
801 471	4 o'clock	3 o'clock	Black	Gold
801 465	4 o'clock	3 o'clock	Gold	Black
878 210	3 o'clock	3 o'clock	White	Black

TECHNICAL GUIDE

Cal. Y621A

• The explanation here is only for the particular points of Cal. Y621A.

⑱ Oscillating weight with ball-bearing

The inside of the hole is threaded to accept the screw fixed to the barrel and train wheel bridge. When installing the oscillating weight, first set the first reduction wheel so that its hole aligns with the upper of the two holes for the balance cock (see the illustration on the right). Then set the middle point of the oscillating weight so that it faces toward the winding stem, and tighten the oscillating weight with a large driver.

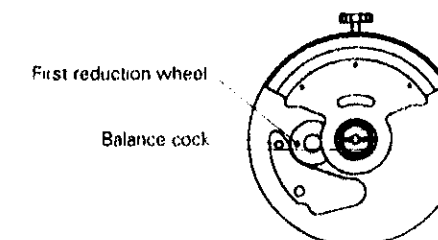

⑳ Second reduction wheel

Lubricate the portions marked with the lubricating marks.

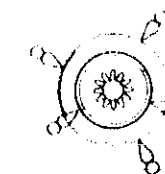

㉑ Barrel and train wheel bridge

Before setting the barrel and train wheel bridge to the main plate, set the first reduction wheel, the pawl lever and the first reduction wheel holder to the bridge.

㉒ First reduction wheel holder

• Disassembling method

• Assembling method

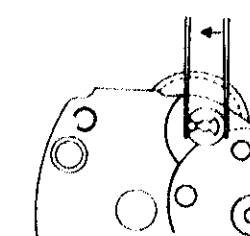
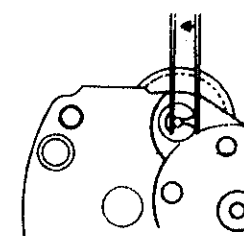

㉓ First reduction wheel

Lubricate the shaded portions.

